

NEOLEPENISM HOUSE

The new Green Technology with roots in Prehistory

Author: Nenad B. Miloradović

www.neolepenism.house

neolepenism@gmail.com

Space design can be one of the strategies for designing low-energy houses. Neolepenism is type of energy efficient architecture with roots in the prehistoric culture of Lepenski Vir (Serbia). This industrial design could significantly contribute to the reduction of heat losses (in winter) or gains (during summer), reducing greenhouse gas emissions and saving energy, building materials and thermal insulation, primarily by its compact shape. It's distinctly mathematical architecture, based on the adaptation of the object to the natural environment. In this way, neolepenism could have a positive impact on global warming and climate change as the passive means of protection.



EXTERIOR OF THE MODEL

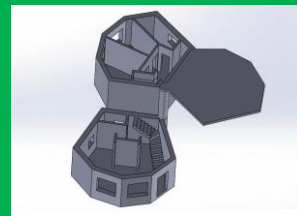

THE MODEL INSIDES

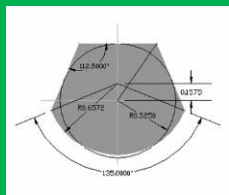

CALCULATED BASIS
BY AUTHOR

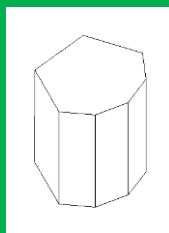

AUTHOR'S COPYRIGHTED
FORM BY WIPO

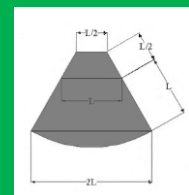

BASIS AT LEPENSKI VIR
BY D. SREJOVIĆ

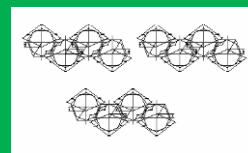

POSSIBILITIES OF URBANISM